

EX-T4V7H 355-11ZUE-3G/D



- Ex certified
- Metal enclosure
- 66,7 mm x 76 mm x 38 mm
- 3 cable entries M 20 x 1.5
- only for positioning tasks
- Mounting details to EN 50041
- Good resistance to oil and petroleum spirit
- Actuator heads can be repositioned by 4 x 90°
- Including Ex-certified screwed cable gland and screw plug

Data

Ordering data

Product type description EX-T4V7H 355-11ZUE-3G/D

Explosion protection

Explosion protection: regulations	EN 60079-15 EN 60079-31 IEC 60079-0
Explosion protection zones	22 2
Explosion protection category	3D 3G
Explosion protection designation	⊕ II 3G Ex nC IIC T5 Gc X ⊕ II 3D Ex tc IIIC T90°C Dc X
Manufacturer declaration	ATEX Zone 2 and 22

General data

Product name	EX-T 355 roller lever 7H 2138
Standards	IEC 60947-5-1 BG-GS-ET-15
Housing construction form	Norm construction design
Enclosure material	Light alloy die-casting

Enclosure coating material	Painted
Material of the contacts, electrical	Silver
Lever material	Metal film
Roller material	Plastic

General data - Features

Safety functions	Yes
Number of auxiliary contacts	1
Number of safety contacts	1

Safety appraisal

Standards	ISO 13849-1
Mission Time	20 Year(s)

Safety appraisal - Safety outputs

B10d Normally-closed contact (NC)	20,000,000 Operations
-----------------------------------	-----------------------

Mechanical data

Actuating element	Roller lever
Mechanical life, minimum	30,000,000 Operations
Impact energy, maximum	1 J
Actuating speed, maximum	2.5 m/s
Note (Actuating speed)	Actuating speed with actuating angle 30° to switch axis
Note (Switchover time)	Switchover time in accordance with actuating speed
Actuating torque, minimum	0.3 Nm

Mechanical data - Connection technique

Terminal Connector	Screw connection
Cable cross-section of the cable glands, minimum	7 mm
Cable cross-section of the cable glands, maximum	12 mm
Cable section, minimum	0.75 mm ²
Cable section, maximum	2.5 mm ²
Note (Cable section)	All indications about the cable section are including the conductor ferrules.
Wire cross-section	13 AWG

Mechanical data - Dimensions

Length of sensor	57.3 mm
Width of sensor	40.5 mm
Height of sensor	183 mm

Ambient conditions

Degree of protection	IP67
Ambient temperature, minimum	-20 °C
Ambient temperature, maximum	+60 °C

Ambient conditions - Insulation value

Rated impulse withstand voltage U_{imp}	6 kV
-------------------------------------------	------

Electrical data

Thermal test current	10 A
Utilisation category AC-15	230 VAC
Utilisation category AC-15	4 A
Utilisation category DC-13	24 VDC
Utilisation category DC-13	1 A
Switching element	NO contact, NC contact
Switching principle	Slow action with overlapping contacts
Bounce duration, maximum	2 ms
Switching frequency	5,000 /h

Ordering code

Product type description:

EX-(1)(2) 355-(3)Z(4)-(5)-(6)-(7)-3G/D

(1)

Z Snap action

T Slow action (not for AF/S)

(2)

S Plunger S

R Roller plunger R

H Roller lever H

10H Rod lever 10H

7H Roller lever 7H

7H-2138 Roller lever 7H for position switches with safety function

1K Offset roller lever 1K

3K Angle roller lever 3K

(3)

11 1 NO contacts/1 NC contact

02 2 NC contact

20 2 NO contacts (not suitable for safety applications)

01/01 1 NC contact left / 1 NC contact right

12 1 NO contact/2 NC contacts

03 3 NC contact

(4)

H Slow action with staggered contacts

UE Slow action with overlapping contacts

(5)

1297 Enclosure with transverse slotted holes

(6)

2138 Roller lever 7H for position switches with safety function

(7)

1637 Gold-plated contacts

Pictures

Product picture (catalogue individual photo)



ID: k355hf02

| 483,4 kB | .jpg | 188.383 x 369.358 mm - 534 x 1047

Pixel - 72 dpi

| 98,9 kB | .png | 74.083 x 144.992 mm - 210 x 411

Pixel - 72 dpi

Dimensional drawing basic component

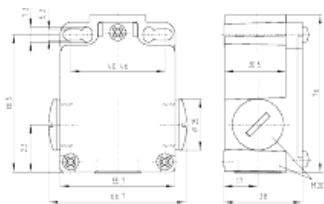

ID: k-355g01

| 133,4 kB | .jpg | 352.778 x 215.9 mm - 1000 x 612

Pixel - 72 dpi

| 30,4 kB | .cdr |

| 4,4 kB | .png | 74.083 x 45.156 mm - 210 x 128 Pixel

- 72 dpi

Switch travel diagram

ID: kh335s03

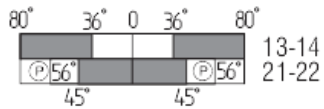

| 2,1 kB | .png | 74.083 x 24.342 mm - 210 x 69 Pixel - 72 dpi

| 31,9 kB | .cdr |

| 66,4 kB | .jpg | 352.778 x 115.711 mm - 1000 x 328 Pixel - 72 dpi

Dimensional drawing actuator

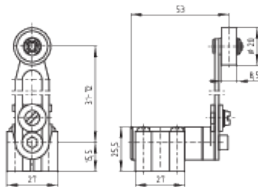

ID: 1h355g02

| 30,2 kB | .cdr |

| 104,9 kB | .jpg | 352.778 x 243.769 mm - 1000 x 691 Pixel - 72 dpi

| 9,6 kB | .png | 74.083 x 51.153 mm - 210 x 145 Pixel - 72 dpi

K.A. Schmersal GmbH & Co. KG, Möddinghofe 30, D-42279 Wuppertal

The details and data referred to have been carefully checked. Images may diverge from original. Further technical data can be found in the manual. Technical amendments and errors possible.

Generated on 07/05/2021 04:22:13