

## AZ16-12ZI-B1-M16



- Long life
- Double-insulated
- Individual coding
- 52 mm x 90 mm x 30 mm
- Insensitive to soiling
- Thermoplastic enclosure
- Large wiring compartment
- 3 cable entries M 16 x 1.5
- Coding level "High" according to ISO 14119
- Slotted holes for adjustment, circular holes for location
- High level of contact reliability with low voltages and currents

### Data

#### Ordering data

Product type description	AZ 16-12ZI-B1
Article number (order number)	101150050
EAN (European Article Number)	4030661154442
eCl@ss number, Version 9.0	27-27-26-02
eCl@ss number, Version 11.0	27-27-26-02

#### Approval - Standards

Certificates	TÜV EAC
--------------	------------

#### General data

Product name	AZ 16ZI
Coding level according to ISO 14119	High
Enclosure material	Plastic, glass-fibre reinforced thermoplastic, self-extinguishing
Material of the actuator	Stainless steel
Material of the contacts, electrical	Silver
Gross weight	158 g

#### General data - Features

Ejection force	Yes
----------------	-----

Number of auxiliary contacts	1
Number of safety contacts	2

### Safety appraisal

Standards	BG-GS-ET-15 ISO 13849-1 EN 60947-5-1
Mission Time	20 Year(s)

### Safety appraisal - Safety outputs

B10d Normally-closed contact (NC)	2,000,000 Operations
B10d Normally open contact (NO)	1,000,000 Operations
Note (B10d Normally open contact (NO))	at 10% $I_e$ and ohmic load

### Mechanical data

Actuating radius, minimum	250 mm
Actuator	straight rigid
Mechanical life, minimum	1,000,000 Operations
positive break travel	8 mm
Positive break force, minimum	20 N
Actuating speed, maximum	2 m/s

### Mechanical data - Connection technique

Terminal Connector	Screw connection
Cable section, minimum	0.75 mm <sup>2</sup>
Cable section, maximum	2.5 mm <sup>2</sup>
Note (Cable section)	All indications about the cable section are including the conductor ferrules.

### Mechanical data - Dimensions

Length of sensor	30 mm
Width of sensor	52 mm
Height of sensor	90 mm

### Ambient conditions

Degree of protection	IP 67 to IEC/EN 60529
Ambient temperature, minimum	-30 °C
Ambient temperature, maximum	+80 °C

## Ambient conditions - Insulation value

Rated impulse withstand voltage U<sub>imp</sub> 6 kV

## Electrical data

Thermal test current 10 A  
Switching element NO contact, NC contact  
Switching principle Creep circuit element

## Electrical data - Safety contacts

Voltage, Utilisation category AC15 230 VAC  
Current, Utilisation category AC-15 4 A  
Voltage, Utilisation category DC13 24 VDC  
Current, Utilisation category DC13 4 A

## Electrical data - Auxiliary contacts

Voltage, Utilisation category AC15 230 VAC  
Current, Utilisation category AC-15 4 A  
Voltage, Utilisation category DC13 24 VDC  
Current, Utilisation category DC13 4 A

## Scope of delivery

Included in delivery Slot sealing plugs  
Delivery scope of Mounting material Tamperproof screws

## Notes

Note (General) The axis of the hinge must be 5 mm above and in a parallel plane to the top surface of the safety switch.  
Minimum actuating radius on hinged guards 250 mm  
The actuator is not available separately.

## Ordering code

Product type description:

AZ 16-(1)ZI-(2)-(3)

(1)

**03** 3 NC contact

**12** 1 NO contact/2 NC contacts

(2)

**B1** straight design

**B1-1747** straight design with magnetic latch

**B1-2024** straight design with slot-lip seal

**B1-2053** straight design with ball latch

**B1-2177** straight design with centering guide

**B6L** angled, flexible to the left

**B6R** angled, flexible to the right

(3)

**M16** cable entry M16

**M20** Cable entry M20

## Pictures

### Product picture (catalogue individual photo)



ID: kaz16f11

| 64,3 kB | .png | 73.731 x 143.581 mm - 209 x 407  
Pixel - 72 dpi

| 674,9 kB | .jpg | 352.778 x 685.094 mm - 1000 x  
1942 Pixel - 72 dpi

### Dimensional drawing basic component

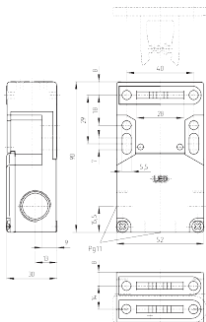

ID: kaz16gi1

| 49,5 kB | .cdr |

| 283,3 kB | .jpg | 352.778 x 548.569 mm - 1000 x  
1555 Pixel - 72 dpi

| 8,1 kB | .png | 74.083 x 115.006 mm - 210 x 326  
Pixel - 72 dpi

### Switch travel diagram

ID: kaz16si7



| 1,3 kB | .png | 73.731 x 104.422 mm - 209 x 296  
Pixel - 72 dpi

| 58,8 kB | .jpg | 352.778 x 159.456 mm - 1000 x 452  
Pixel - 72 dpi

## Diagram

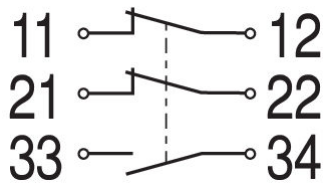

ID: k2o1sk04

| 16,0 kB | .cdr |

| 80,6 kB | .jpg | 352.778 x 195.439 mm - 1000 x 554

Pixel - 72 dpi

## Dimensional drawing actuator

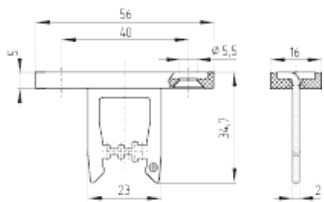

ID: kaz16bi2

| 91,2 kB | .jpg | 352.778 x 217.664 mm - 1000 x 617

Pixel - 72 dpi

| 3,4 kB | .png | 74.083 x 45.861 mm - 210 x 130 Pixel

- 72 dpi

## Actuating radius

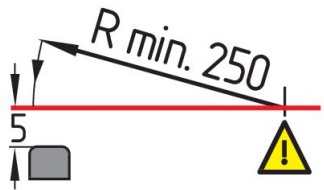

ID: kaz16ri2

| 22,6 kB | .cdr |

## Actuating radius

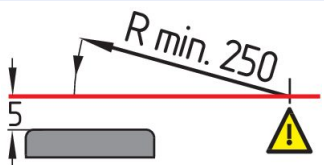

ID: kaz16ri1

| 25,1 kB | .cdr |

K.A. Schmersal GmbH & Co. KG, Möddinghofe 30, D-42279 Wuppertal

The details and data referred to have been carefully checked. Images may diverge from original. Further technical data can be found in the manual. Technical amendments and errors possible.

Generated on 19/05/2021 05:46:44